



**Aldreds**  
Estate Agents

75 Yew Tree Close

Bradwell, NR31 8NZ

£230,000





## 75 Yew Tree Close

Bradwell, NR31 8NZ

This charming two-bedroom semi-detached bungalow, located in a desirable cul-de-sac in Bradwell, offers excellent project potential for those looking to create their ideal home. The property boasts two comfortable double bedrooms and benefits from UPVC double glazing throughout, ensuring warmth and energy efficiency.

Further enhancing its appeal, the bungalow includes convenient off-road parking and a detached garage, providing ample space for vehicles and storage. Its prime location offers easy access to transport links and local amenities, making it a highly desirable option for comfortable living with everything you need close at hand.

### Entrance hall

Carpet floor, double glazed front door, radiator, loft hatch, access to lounge, 2 bedrooms, shower room and kitchen, built in cupboard with electric fuse box.

### Lounge

11'9" x 15'8" (3.6m x 4.8m)

Carpet floor, radiator, double glazed window to front, gas fire place.

### Kitchen

14'9" x 9'10" (4.5m x 3.0m)

Carpet floor, double glazed door to side, double glazed windows to rear and side, boiler unit, cupboard containing immersion tank, pantry cupboard, laminate counter tops, space for free standing cooker and fridge freezer, sink and draining board, wall mounted and under counter cupboard.

### Shower Room

8'10" x 6'10" (max) (2.7m x 2.1m (max))

Vinyl floor, radiator, WC, basin, shower cubicle with wall mounted shower, double glazed window to side.

### Bedroom 1

11'9" x 13'1" (3.6m x 4.0)

Carpet floor, double glazed window to rear, radiator.

### Bedroom 2

8'10" x 9'10" (2.7m x 3.0m)

Carpet floor, double glazed window to front, radiator







### Garage

Up and over door, double glazed door and window to side, concrete floor, electricity connection.

### Outside Front

Grass lawn area, concrete driveway leading to garage, concrete path to front door.

### Outside Rear

Grass lawn, timber fence boundaries, mixed shrubs, side access to garage.

### Services

Mains water, electric, gas, drainage.

### Council Tax

Great Yarmouth Borough Council - Band B

### Tenure

Freehold

### Location

Bradwell is a popular residential area adjoining Gorleston 2 miles from Great Yarmouth Town centre \* There are a variety of local shops \* Schools \* Medical centre \* Regular bus services to the main shopping areas \* Indoor swimming pool and recreation areas.

### Directions

From the Gorleston office head south along the High Street, at the traffic lights turn right into Church Lane, continue over the roundabout and the next set of traffic lights into Crab Lane, at the 'T' junction turn left into Beccles Road, at the traffic lights take the second turning right into Church Lane, continue into Lords Lane, turn left into Yew Tree Close

### What3Words

///producers.mimics.punk

### Ref

G18338/07/25



Floor Plan

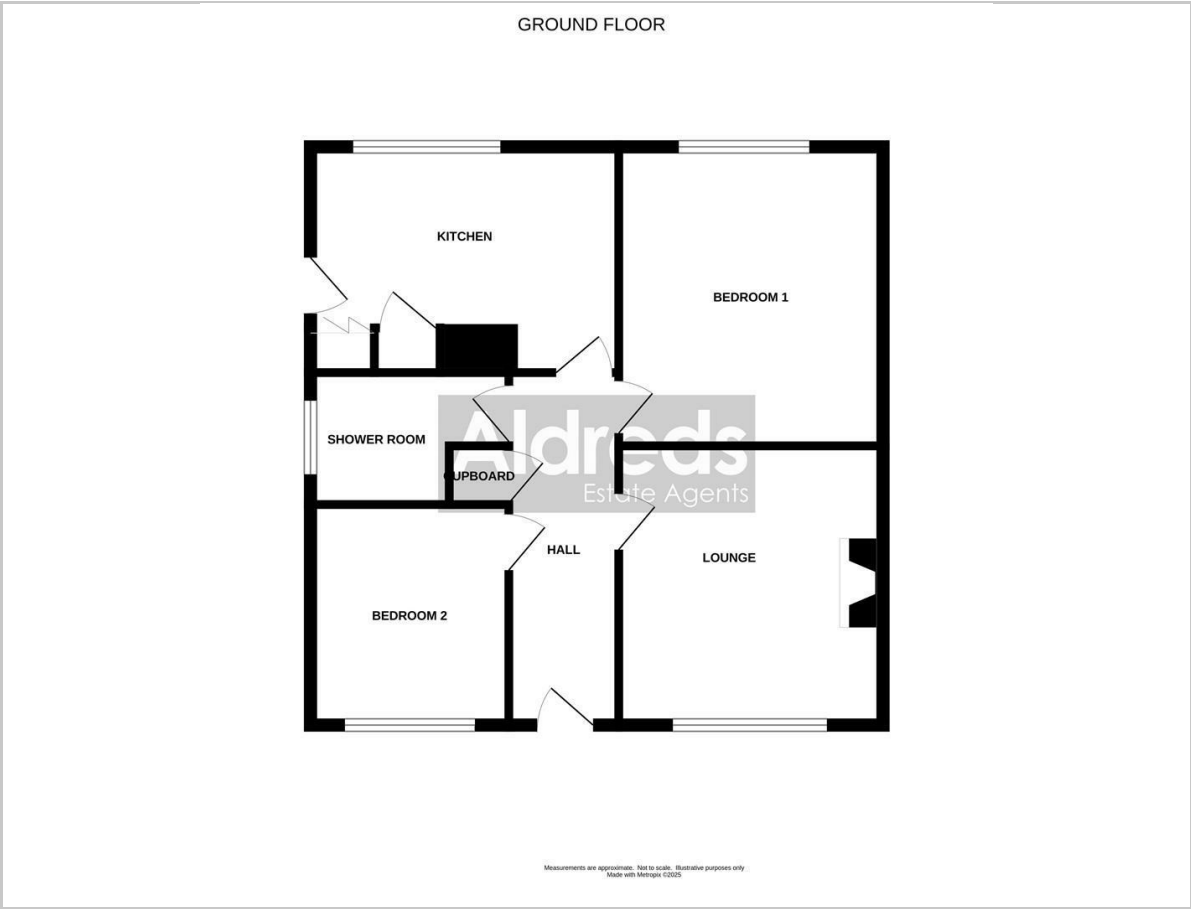

Viewing

Please contact our Aldreds Gorleston Office on 01493 664600 if you wish to arrange a viewing appointment for this property or require further information.

Disclaimer

These particulars are issued on an understanding that all negotiations shall be conducted through Messrs. Aldreds. Please note: Messrs. Aldreds for themselves and for the vendors or lessors of this property whose agents they are given notice that: 1. Particulars are set out as a general outline only for guidance of intending purchasers or lessees, and do not constitute nor constitute part of, an offer or contract. 2. All descriptions, dimensions, references to condition and necessary permissions for use and occupation, and other details are given without responsibility and any intending purchasers or tenants should not rely on them as statements or representations of fact but must satisfy themselves by inspection or otherwise as to the correctness of each of them. 3. No person in the employment of Messrs. Aldreds has any authority to make or give any representation or warranty whatever in relation to this property. 4. If you are proposing to visit the property and are travelling some distance please check with Aldreds on the issue of availability prior to travelling. 5. Aldreds Property Consultants and associated services may offer additional services to the prospective purchaser for which they will be entitled to receive a commission.

Aldreds are pleased to be working with Mortgage Advice Bureau. They're an award-winning mortgage broker with over 1,400 advisers across the UK, and have access to over 12,000 mortgage products from over 90 lenders. Aldreds Estate Agents Ltd receive a commission of £200 on each completed case. Your home may be repossessed if you do not keep up repayments on your mortgage. There may be a fee for mortgage advice. The actual amount you pay will depend upon your circumstances. The fee is up to 1%, but a typical fee is 0.3% of the amount borrowed. Mortgage Advice Bureau is a trading name of Mortgage Seeker Limited which is an appointed representative of Mortgage Advice Bureau Limited and Mortgage Advice Bureau (Derby) Limited which are authorised and regulated by the Financial Conduct Authority. Mortgage Seeker Limited Registered Office: Lovewell Blake, Sixty Six North Quay, Great Yarmouth, Norfolk, NR30 1HE. Registered in England Number: 03721415. 6. Potential purchasers should check with their providers that the broadband and mobile phone coverage they would require is available.

Area Map



Energy Efficiency Graph

